

TEAM PRIDE LIGHT

PROJECT YOUR TEAM'S LOGOS OUTSIDE OR INSIDE

INSTRUCTIONS:

1. Determine proper placement of Light such that there is nothing blocking the light and the surface to illuminate.
2. For outdoors: use included lawn stake. Insert lawn stake into ground/lawn at dedicated location. Once lawn stake is firmly in the ground, attach Light component on top.

Indoor use: attach included tripod.

3. The positive polarity of cable(+) should always be connected to the positive polarity of DC adaptor (+) and it should match the locking slot of the adaptor.
4. Check that all connection is correct plugged in and screws the locking nut of cable.
Warning: Before starting the cable installation, be sure to unplug the adaptor. If the power is left on during installation, fire, electrical shock may occur.
5. Adjust to desired projection angle by using the black knob on the side of the Light underneath component. Tighten again once correct angle is obtained.
6. Use outdoor extension cord (not included) to plug into power supply. Extension cord to be plugged into a 120V 50/60Hz outlet.
7. To turn on Light press the red button once on the back of the Light component (Light will be on rotation mode when started). Pressing the red button once will stop the Light from rotating. Pressing red button twice will turn the Light off.
8. For safety purposes Light automatically shuts off after 8 hours

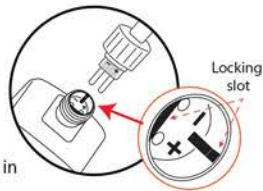

9. This unit is not intended for use by persons (including children) with reduced physical, sensory or mental capabilities, or lack of experience or knowledge, unless they have been given supervision or instruction concerning use of Light by a person responsible for their safety. Children should be supervised to ensure they do not play with the unit.
10. Do not operate with damaged plug.
11. Do not disassemble charger. Disassembly may result in risk of electrical shock or fire.
12. To reduce the risk of electrical shock, unplug the charger from the outlet when not in use.
13. Do not operate unit if it has been subjected to damage of any kind.

CAUTION: Avoid direct eye contact light. Never expose your eyes or others to direct light.

FOR INDOOR AND OUTDOOR USE - RAIN TIGHT RATING IP44

ADAPTOR VOLTAGE: AC 100-240V 50/60HZ

INPUT VOLTAGE: DC 15V 1.2A

EACH LED POWER: 2.5W

COLOR TEMPERATURE: 6000K~8000K Cool White

OPERATION TEMPERATURES: -17F ~ 100F

PROJECTION DISTANCE: 25~50 FEET



INCLUDED COMPONENTS:



SAFETY INSTRUCTIONS:

1. Always be cautious when using electrical products.
2. Read and follow all safety instructions.
3. Reference National Code, ANSI/NFPA 70, for installations of wiring and clearances from power and lighting conductors.
4. Installation work and electrical wiring must be done by qualified person(s) in accordance with all applicable codes and standards, including fire-rated construction.
5. For a direct plug-in unit, do not install or use within 10 feet of a pool/water.
6. Do not use in a bathroom.
CAUTION: RISK OF ELECTRICAL SHOCK. Do not use with extension cord near water or where water may accumulate. Keep Light at least 16 feet away from pools and spas. Keep plugs and receptacles dry.
7. **WARNING: Risk of Electrical Shock.** When used outdoors, install only to a covered class A GFCI protected receptacle. If one is not available, contact a qualified electrician for proper installation. Ensure that the power unit and cord do not interfere with completely closing the receptacle cover.
8. **WARNING: Risk of Fire.** Installation involves special wiring methods to run wiring through a building's structure. Consult a qualified electrician.

CAUTION: TO REDUCE THE RISKS ASSOCIATED WITH LED BRIGHT LIGHT - DO NOT STARE DIRECTLY INTO THE PROJECTOR LENS

CAUTION: TO REDUCE THE RISK ASSOCIATED WITH INTENSE VISIBLE LIGHT - DO NOT USE THIS PROJECTOR AROUND UNSUPERVISED CHILDREN

Do not block any ventilation openings. To ensure reliable operation of the projector and to protect from over heating, it is recommended to install the projector in a location that does not block ventilation. As an example, do not place the projector on a crowded table, sofa, bed, etc. Do not put the projector in an enclosure such as a book case or a cabinet that restricts air flow.

Do not install near heat sources such as radiators, heaters, stoves or any other apparatus such as amplifiers that emits heat.

Only use attachments/accessories specified by the manufacturer.

Do not attempt to service the unit yourself. Opening or removing covers may expose you to dangerous voltages or other hazards.

If the projector fan fails, turn off the projector when overheated. Turn ON again after the projector cools down.

Do not use the projector in direct sunlight.

Do not use near any appliance generating a strong magnetic field.

Do not touch the projector for a long time while the projector is used.

Image is too small or too large

• Move the projector closer to or further from the screen

Changes or modifications not expressly approved by the party responsible for compliance could void the user's authority to operate this device.

FCC statement:

This device complies with part 15 of the FCC Rules

Operation is subject to the following two conditions:

1. This device may not cause harmful interference, and
2. This device must accept any interference, including interference that may cause undesired operation

Note: This equipment has been tested and found to comply with the limits for a Class B digital device, pursuant to part 15 of the FCC Rules. These limits are designed to provide reasonable protection against harmful interference in a residential installation. This equipment generates, uses and can radiate radio frequency energy and, if not installed and used in accordance with the instructions, may cause harmful interference to radio communications.

However, there is no guarantee that interference will not occur in a particular installation. If this equipment does cause harmful interference to radio or television reception, which can be determined by turning the equipment off and on, the user is encouraged to try to correct the interference by one or more of the following measures:

- Reorient or relocate the receiving antenna
- Increase the separation between the equipment and receiver
- Connect the equipment into an outlet on a circuit different from that to which the receiver is connected.
- Consult the dealer or an experienced radio/TV technician for help

SAVE THESE INSTRUCTIONS - This manual contains important safety and operating instructions for power units.

TM & © 2017 FABRIQUE INNOVATIONS INC. • SPORTCULTURE™
ALL RIGHTS RESERVED • MADE IN CHINA
DISTRIBUTED BY FABRIQUE INNOVATIONS INC., NEW YORK, NY 10018

TEAM PRIDE LIGHT

PROJECT YOUR TEAM'S LOGOS OUTSIDE OR INSIDE

INSTRUCTIONS:

1. Determine proper placement of Light such that there is nothing blocking the light and the surface to illuminate.
2. For outdoors: use included lawn stake. Insert lawn stake into ground/lawn at dedicated location. Once lawn stake is firmly in the ground, attach Light component on top.

Indoor use: attach included tripod.

3. The positive polarity of cable (+) should always be connected to the positive polarity of DC adaptor (+) and it should match the locking slot of the adaptor.

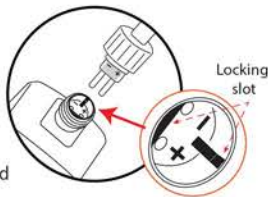

4. Check that all connection is correct plugged in and screws the locking nut of cable.

Warning: Before starting the cable installation, be sure to unplug the adaptor. If the power is left on during installation, fire, electrical shock may occur.

5. Adjust to desired projection angle by using the black knob on the side of the Light underneath component. Tighten again once correct angle is obtained.
6. Use outdoor extension cord (not included) to plug into power supply. Extension cord to be plugged into a 120V 50/60Hz outlet.
7. To turn on Light press the red button once on the back of the Light component (Light will be on rotation mode when started). Pressing the red button once will stop the Light from rotating. Pressing red button twice will turn the Light off.
8. For safety purposes Light automatically shuts off after 8 hours

9. This unit is not intended for use by persons (including children) with reduced physical, sensory or mental capabilities, or lack of experience or knowledge, unless they have been given supervision or instruction concerning use of Light by a person responsible for their safety. Children should be supervised to ensure they do not play with the unit.

10. Do not operate with damaged plug.

11. Do not disassemble charger. Disassembly may result in risk of electrical shock or fire.

12. To reduce the risk of electrical shock, unplug the charger from the outlet when not in use.

13. Do not operate unit if it has been subjected to damage of any kind.

CAUTION: Avoid direct eye contact light. Never expose your eyes or others to direct light.

FOR INDOOR AND OUTDOOR USE - RAIN TIGHT RATING IP44

ADAPTOR VOLTAGE: AC 100-240V 50/60HZ

INPUT VOLTAGE: DC 15V 1.2A

EACH LED POWER: 2.5W

COLOR TEMPERATURE: 6000K~8000K Cool White

OPERATION TEMPERATURES: -17F ~ 100F

PROJECTION DISTANCE: 25~50 FEET



CAUTION: TO REDUCE THE RISKS ASSOCIATED WITH LED BRIGHT LIGHT - DO NOT STARE DIRECTLY INTO THE PROJECTOR LENS

CAUTION: TO REDUCE THE RISK ASSOCIATED WITH INTENSE VISIBLE LIGHT - DO NOT USE THIS PROJECTOR AROUND UNSUPERVISED CHILDREN

Do not block any ventilation openings. To ensure reliable operation of the projector and to protect from over heating, it is recommended to install the projector in a location that does not block ventilation. As an example, do not place the projector on a crowded table, sofa, bed, etc. Do not put the projector in an enclosure such as a book case or a cabinet that restricts air flow.

Do not install near heat sources such as radiators, heaters, stoves or any other apparatus such as amplifiers that emits heat.

Only use attachments/accessories specified by the manufacturer.

Do not attempt to service the unit yourself. Opening or removing covers may expose you to dangerous voltages or other hazards.

If the projector fan fails, turn off the projector when overheated. Turn ON again after the projector cools down.

Do not use the projector in direct sunlight.

Do not use near any appliance generating a strong magnetic field.

Do not touch the projector for a long time while the projector is used.

Image is too small or too large

- Move the projector closer to or further from the screen

Changes or modifications not expressly approved by the party responsible for compliance could void the user's authority to operate this device.

FCC statement:

This device complies with part 15 of the FCC Rules

Operation is subject to the following two conditions:

1. This device may not cause harmful interference, and
2. This device must accept any interference, including interference that may cause undesired operation

Note: This equipment has been tested and found to comply with the limits for a Class B digital device, pursuant to part 15 of the FCC Rules. These limits are designed to provide reasonable protection against harmful interference in a residential installation. This equipment generates, uses and can radiate radio frequency energy and, if not installed and used in accordance with the instructions, may cause harmful interference to radio communications.

However, there is no guarantee that interference will not occur in a particular installation. If this equipment does cause harmful interference to radio or television reception, which can be determined by turning the equipment off and on, the user is encouraged to try to correct

the interference by one or more of the following measures:

- Reorient or relocate the receiving antenna
- Increase the separation between the equipment and receiver
- Connect the equipment into an outlet on a circuit different from that to which the receiver is connected.
- Consult the dealer or an experienced radio/TV technician for help

SAVE THESE INSTRUCTIONS - This manual contains important safety and operating instructions for power units.

TM & © 2017 FABRIQUE INNOVATIONS INC. • SPORTCULTURE™
ALL RIGHTS RESERVED • MADE IN CHINA
DISTRIBUTED BY FABRIQUE INNOVATIONS INC., NEW YORK, NY 10018

INCLUDED COMPONENTS:



SAFETY INSTRUCTIONS:

1. Always be cautious when using electrical products.
2. Read and follow all safety instructions.
3. Reference National Code, ANSI/NFPA 70, for installations of wiring and clearances from power and lighting conductors.
4. Installation work and electrical wiring must be done by qualified person(s) in accordance with all applicable codes and standards, including fire-rated construction.
5. For a direct plug-in unit, do not install or use within 10 feet of a pool/water.
6. Do not use in a bathroom.

CAUTION: RISK OF ELECTRICAL SHOCK. Do not use with extension cord near water or where water may accumulate. Keep Light at least 16 feet away from pools and spas. Keep plugs and receptacles dry.

7. **WARNING: Risk of Electrical Shock.** When used outdoors, install only to a covered class A GFCI protected receptacle. If one is not available, contact a qualified electrician for proper installation. Ensure that the power unit and cord do not interfere with completely closing the receptacle cover.
8. **WARNING: Risk of Fire.** Installation involves special wiring methods to run wiring through a building's structure. Consult a qualified electrician.